

PROJECT NAME:		TYPE:
DATE:		
SPECIFIER:		
PART NO.:	PREPARED BY:	



6 LED FESTOON LAMPS

GENERAL PURPOSE USE LED LIGHT SOURCE

The LED Festoon lamp product can be used for numerous amounts of installations. This light is light weight and can be installed in various locations with ease. The product is durable, long lasting, and cool to the touch. Fits with all standard festoon sockets.



↑ DIMMABLE

FEATURES AND BENEFITS

- Solid state lighting device, works well in all types of environments
- Instant on, no warm up time required
- Lasts 10 times longer than incandescent
- No mercury, No lead
- No IR, No UV
- Lumen Maintenance: L80 (80% @ 50,000 hrs)
- Fits standard festoon socket (1 7/8")
- Cool, Neutral, and Warm White Colors
- 12VAC/DC operation
- Dimmable, with Low Voltage Magnetic Dimmer

Optional Features:

- Water resistant aluminum housing
- Looped or cartridge style end cap

DIMENSIONS

ACTUAL SIZE

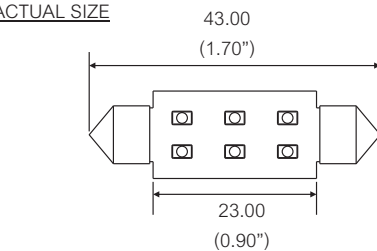

TOP VIEW
Tolerance= +/- 1.0mm (0.025")

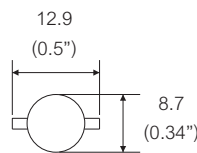

END VIEW

OPTIONAL:
LOOPED END
(CARTRIDGE STYLE)

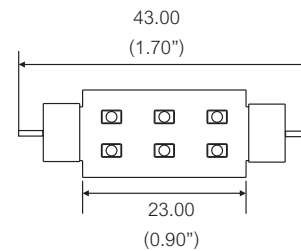

TOP VIEW
NOTE: For cartridge style looped end, the cartridge can be fitted over the LED festoon end cap.



COLORS



*US7,307,391, International Patents Pending



PROJECT NAME:	TYPE:
DATE:	
SPECIFIER:	
PART NO.:	PREPARED BY:



6 LED FESTOON LAMPS

GENERAL PURPOSE USE LED LIGHT SOURCE

OPTIONAL DIMENSIONS

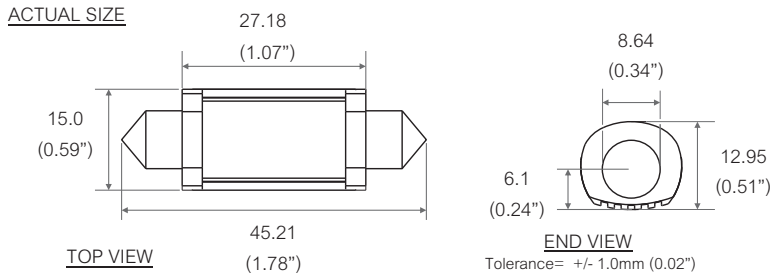

SPECIFICATIONS

Product Part Number	Electrical Specification						Optical Specification				
	Input Voltage (V)			Input Current (mA)	Voltage Type	Power Consumption	Intensity (Estimate)	Viewing angle	Color Temperature (Kelvin)		
	MIN	to	MAX	TYP	AC/DC	(Watt)	(Lumens)	(Degree)	MIN	TYP	MAX
TBD.6C-504	22Vac	to	30Vac	27	24Vac	0.65	66	120	4745	5000	5310
	22Vdc	to	26Vdc	28	24Vdc	0.67	68		3200	3500	3710
TBD.6C-354	22Vac	to	30Vac	27	24Vac	0.65	61		2580	2700	2800
	22Vdc	to	26Vdc	28	24Vdc	0.67	63				
TBD.6C-284	22Vac	to	30Vac	27	24Vac	0.65	55				
	22Vdc	to	26Vdc	28	24Vdc	0.67	56				

Operating Temperature : -30°C(-22°F) to 50°C (122°F)

ORDERING GUIDE

Examples:

TBD-6C-504 = TBD LED Festoon, Cool White, 24V

TBD-6C-284-E = TBD LED Festoon, Warm White, 24V, With Housing

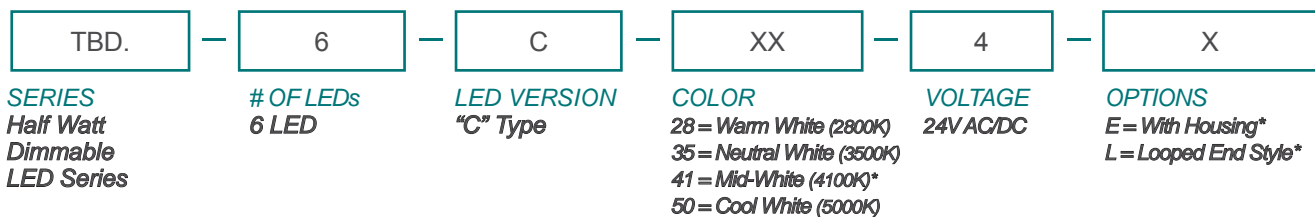

*Special Order, contact TLS for further details.

